

# **Housing and Development (Precincts for Upgrading Works) (Consolidation) Order**

## **Table of Contents**

**1**

**2**

## **THE SCHEDULE**

## **Legislative History**

### **HOUSING AND DEVELOPMENT ACT (CHAPTER 129, SECTION 65B(1))**

### **HOUSING AND DEVELOPMENT (PRECINCTS FOR UPGRADING WORKS) (CONSOLIDATION) ORDER**

**O 4**

**G.N. No. S 130/1996**

**REVISED EDITION 1997**

**(15th June 1997)**

**1.** This Order may be cited as the Housing and Development (Precincts for Upgrading Works) Order.

**2.** The parts of the housing estates of the Board described in the Schedule are hereby declared to be precincts for the purpose of carrying out upgrading works in the precincts.

## **THE SCHEDULE**

## PART I

1. All that part of the housing estate of the Board at Commonwealth Close comprised in Lot numbers 526, 527, 528, 540, 539, 538, 537 and 536 in Mukim 3 and on which Apartment Blocks 81 to 88 are erected, and which is more particularly delineated in Plan 1.

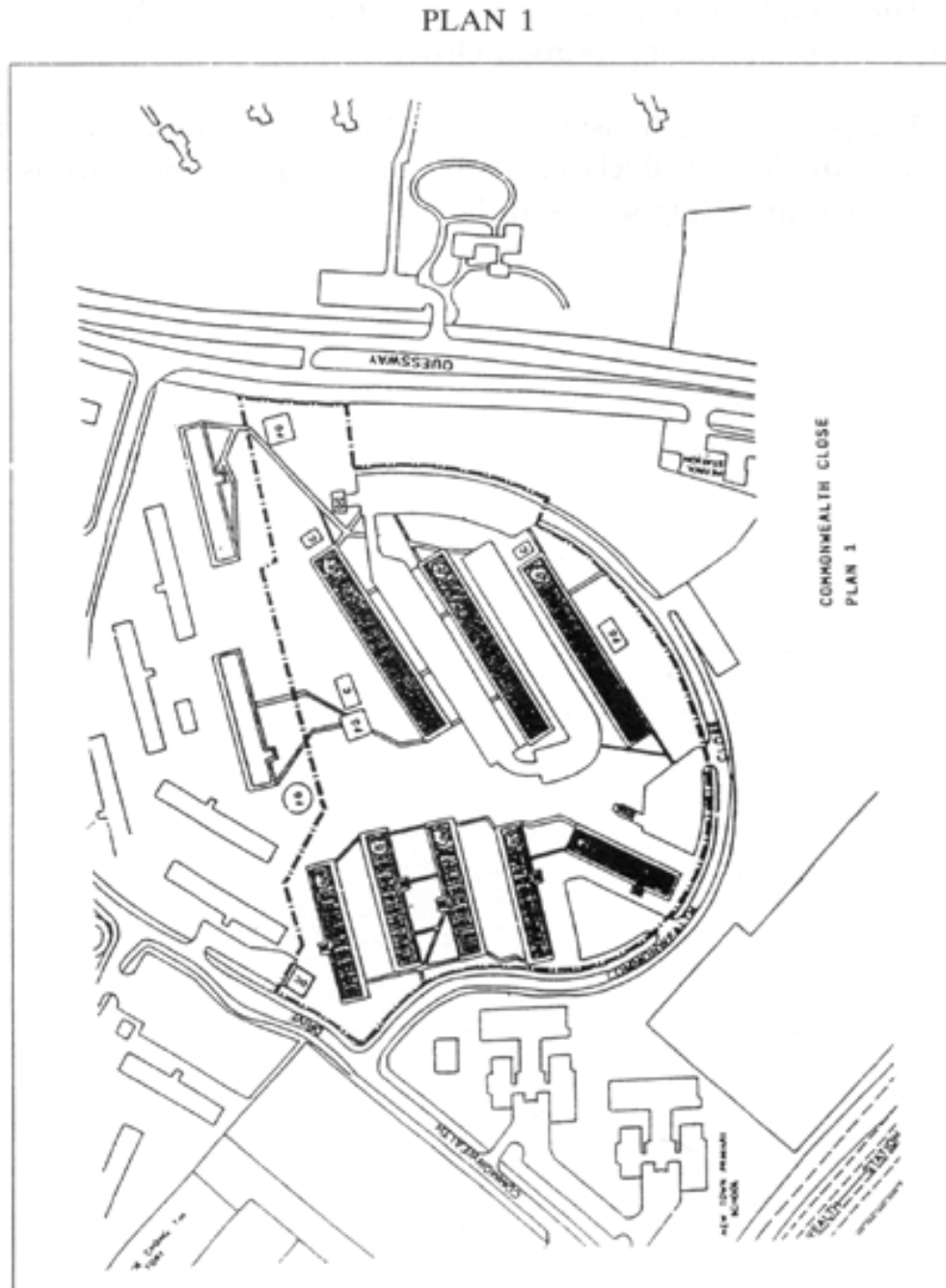

2. All that part of the housing estate of the Board at Kim Tian Road comprised in Lot numbers 1010,

1021, 1022 and 1023 in Mukim 1 and on which Apartment Blocks 128 to 131 are erected, and which is more particularly delineated in Plan 2.

PLAN 2

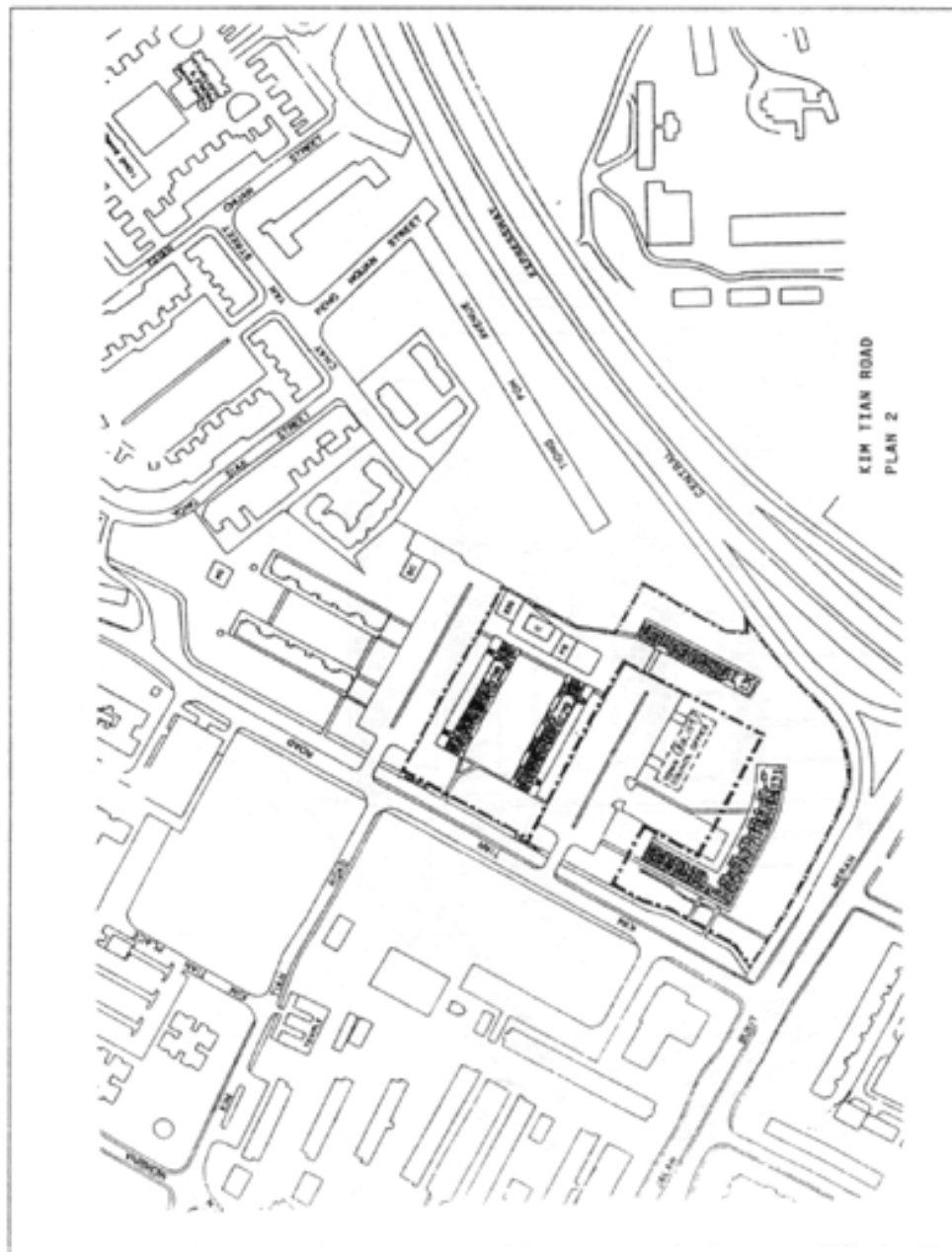

3. All that part of the housing estate of the Board at Ang Mo Kio comprised in Lot numbers 7093, 7094, 7172, 13058 PT, 7059, 7060, 7174, 7173, 7096, 7095 and 7074 in Mukim 18 and on which Apartment Blocks 301, 302, 322 to 329 and 348 are erected, and which is more particularly delineated in Plan 3.

### PLAN 3

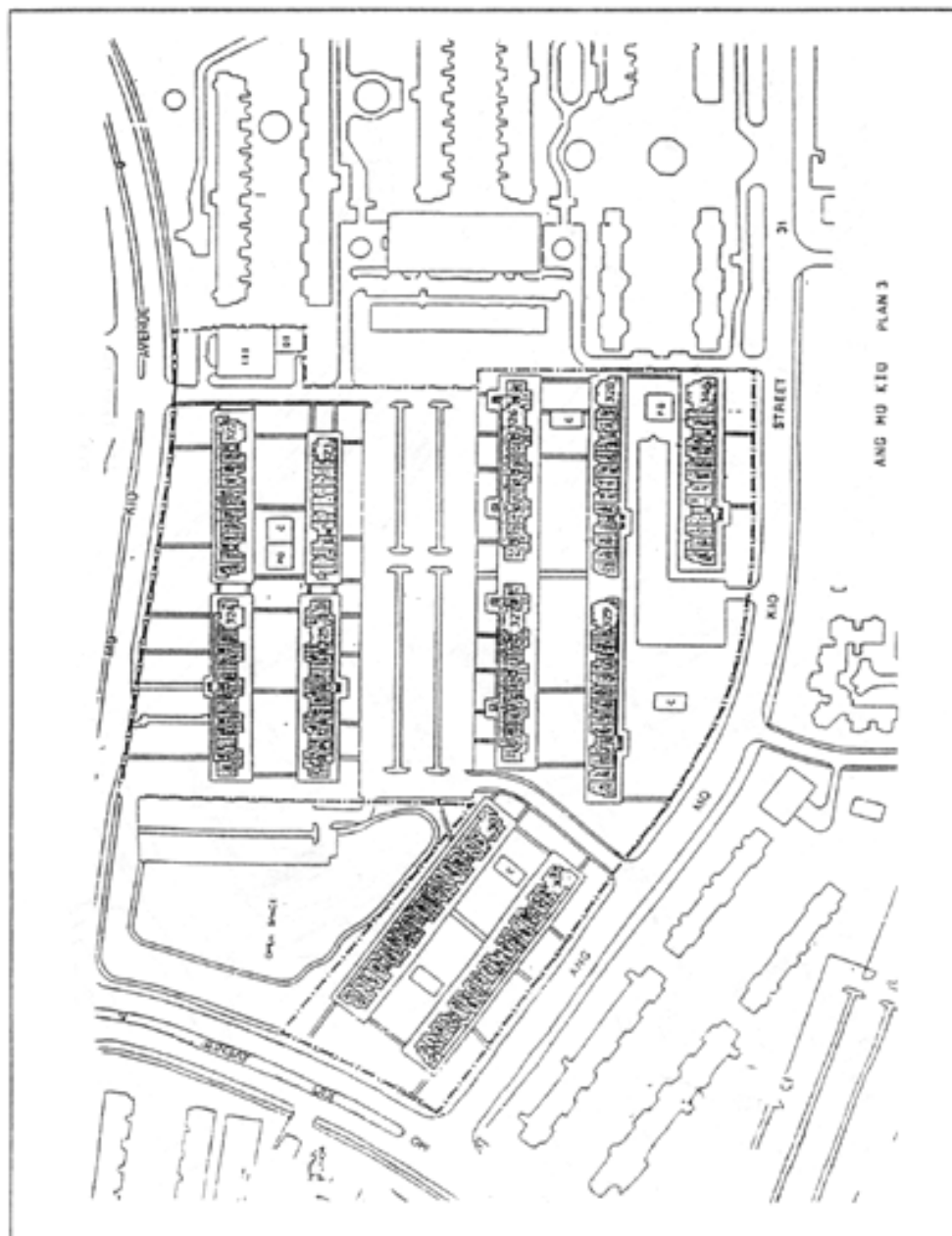

4. All that part of the housing estate of the Board at Geylang East comprised in Lot numbers 5387, 6066 PT, 5388 and 5389 in Mukim 24 and on which Apartment Blocks 95 to 98 are erected, and which is more particularly delineated in Plan 4.

## PLAN 4

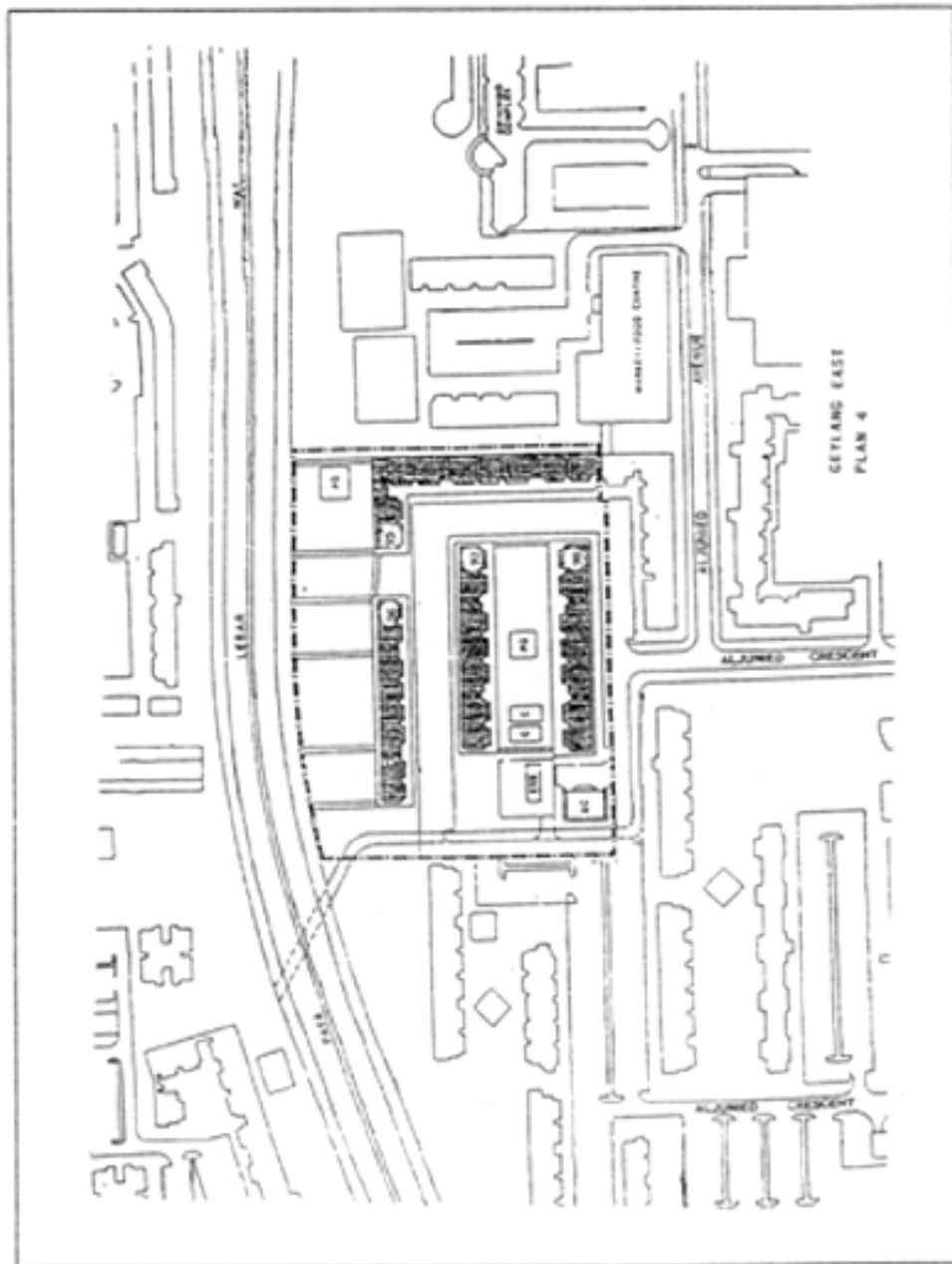

5. All that part of the housing estate of the Board at Sin Ming Road comprised in Lot numbers 4902, 4900, 4899 and 5494 in Mukim 18 and on which Apartment Blocks 22 to 25 are erected, and which is more particularly delineated in Plan 5.